

Vacuum Cleaner S10 / S10 plus



User manual



S10 plus / S10 plus Eco
Item No.: 022.010 / 022.010E



S10
Item No.: 022.000

Cleanfix Reinigungssysteme AG
Stettenstrasse 15
CH-9247 Henau-Uzwil/SG
Tel. +41 71 955 47 47
info@cleanfix.com

www.cleanfix.com

S10 / S10 plus

User manual



1 Unwind power cable

Check the cable, replace it if damaged



2 Open vacuum cleaner

Release the black flap and lift the upper part



3 Lift out filter basket

Replace it if heavily soiled



4 Check dust bag

If it is full, replace it (see "Inserting the dust bag" below)



5 Insert filter basket

Freely applicable, without predetermined position



6 Optional: HEPA-Filter

Replace it if heavily soiled



7 Check motor filter

Replace it if heavily soiled

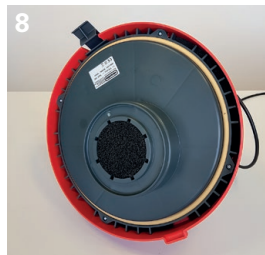

8 Motor filter

Correctly inserted filter



9.1 Close vacuum cleaner 1

Step 1: Guide the upper part at a slight angle into the tab (a)



9.2 Close vacuum cleaner 2

Step 2: Press the flap (b) again



10 Switch on vacuum cleaner

Connect the power cord to power and press the switch

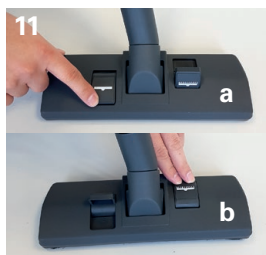

11 Combi floor nozzle

Carpet setting (a)
Hard floor setting (b)



12 Missing air supply

To clean soft textiles, open the air vent



13 Clean combi floor nozzle

After use, remove the nozzle and vacuum it



14 Switch off vacuum cleaner

Press the switch and disconnect the power cord



15 Clean vacuum cleaner

Wipe the entire vacuum cleaner with a slightly damp cloth



16 Winding up the cable

Wind the cable tightly under the black ring

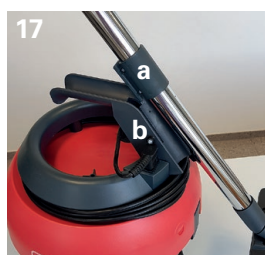

17 Insert suction rod

Insert the slide clamp (a) at the handle (b) (model S10 plus)



18 Suction rod inserted

Only possible with the models S10 plus



19 Storing vacuum cleaner

Optionally wrap the hose around the suction tube

Insert dust bag

We offer dust bags from:

- Textile
- Fleece
- Paper



Clean the dust bag connection in the vacuum cleaner if necessary



Insert the dust bag
Observe the "Top Oben" mark on the dust bag



Plug in the dust bag tightly

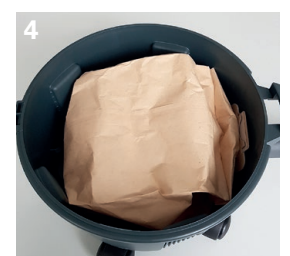

Make sure that the dust bag is evenly positioned



Read the operating instructions before commissioning the machine!
Cleanfix Service-Hotline: 079 357 40 33

www.cleanfix.com